

Air Live
Smart Life  IOT
For Home



Smart Home Kit QIG for APP



● APP Operation Guide

● APP introduce	1
● Devices Setting	4
● Room Setting	6
● Scene Setting	12
● Marco Setting	15
● Advance Setting	22

APP Operation Guide

APP introduce



AirLive SmartLife Plus APP Operation Guide

About the SmartLife Plus APP

AirLive SmartLife Plus APP features "Smart Rules" to make your life easier.

Devices: Turn on/off individual devices.

Room: Create different settings for rooms around the house

Scene: Make multiple actions such as turning on multiple lightings at the same time.

Macro: Set "IF->Then" conditions. For example, if the interior illumination is below certain level, the light will turn on. Enable main security Alarm

APP Operation Guide

APP introduce

01 Execute the SmartLife Plus APP

Click the "AirLive SmartLife Plus" icon on your smart phone



02 Download APP User's Guide

You can click "Question mark" to download the user's guide for APP operation.

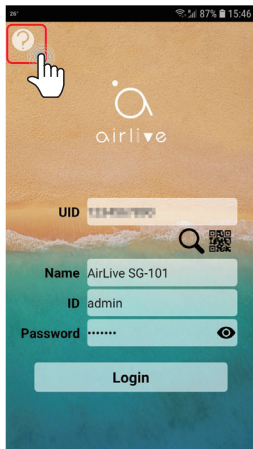

APP Operation Guide

APP introduce

03 Devices Screen

After Login into the Gateway, the APP will display the Scenes page by default to see your devices. Click "Devices" tab, all included sensors should be shown on screen.

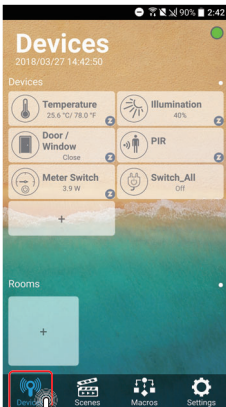

04 Siren

When the Siren is not displayed in the Devices tab, then go to "Setting" >> "Options" and check mark "Show Gateway Siren". The siren will now be shown in the Device tab.

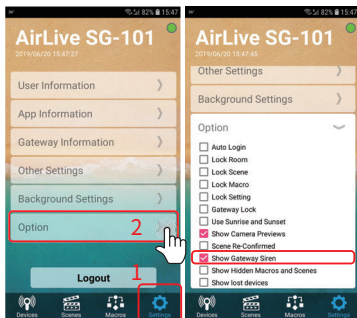

APP Operation Guide

APP introduce / Device Setting

05 Control Info

1. Click the Icon to see the Device information.
2. Click the Text to Activate the Actuator (Sensor cannot be Activated).

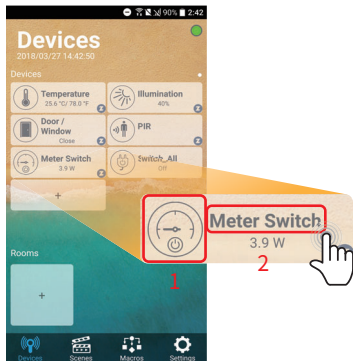

Air Live
Smart Life IOT
For Home

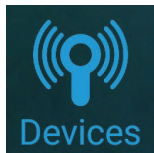

Device Setting

APP Operation Guide

Device Setting

01 Change Sensor's Name-1

- After login the gateway to click "Devices" tab
- Click sensor icon to enter the sensor page.

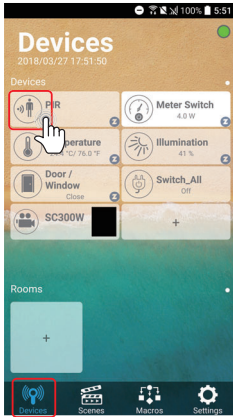

02 Change Sensor's Name-2

You can change the sensor's name.
And you can view sensor's event and other settings.

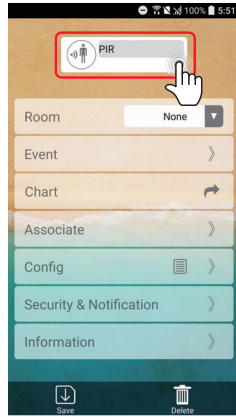

APP Operation Guide

Room Setting

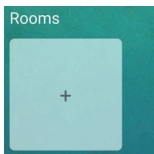

Room Setting

01 Add New Room

Go to Device tab, click "+" icon to create a room.

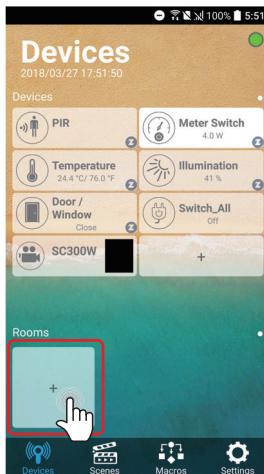

APP Operation Guide

Room Setting

02 Provide a Name for Room

Click "Room name" field and provide a name for the room.

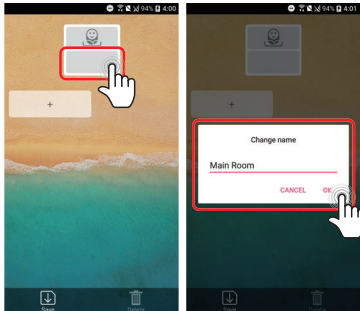

03 Add Sensors in Room

Click "+" to add sensors and Save the room.

Note: Once a sensor has already been placed in a room, it cannot be added to another room.

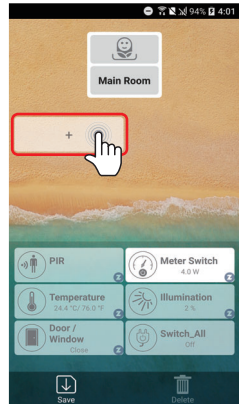

APP Operation Guide

Room Setting

04 Success Add a Room

After creating the room, the new room will show on Rooms.

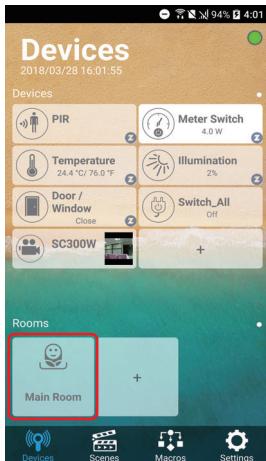

05 Sensors in Room

Click Room name icon to see what sensors in the created Room.

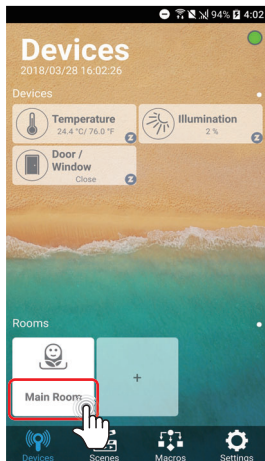

APP Operation Guide

Room Setting

06 Change Room Icon -1

Click Room icon to enter the Room setting page.



07 Change the Room Icon -2

Click icon and select one icon that you want and remember to save the new settings.



APP Operation Guide

Room Setting

08

Delete the sensor from Room-1

Click Room icon to enter the Room setting page.

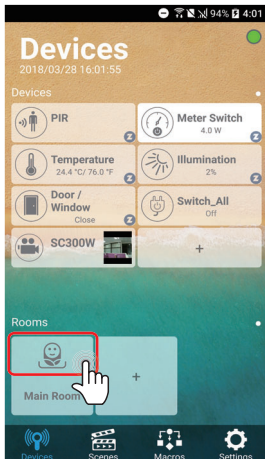

09

Delete the sensor from Room -2

Click "X" to delete the sensor and remember to save the new settings.

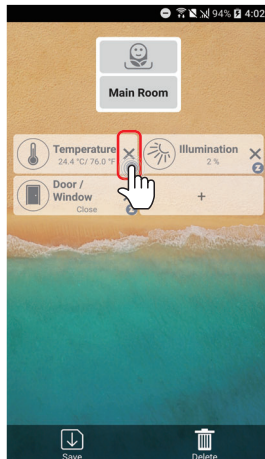

APP Operation Guide

Room Setting

10 Delete the Room -1

Click Room icon to enter the Room setting page.

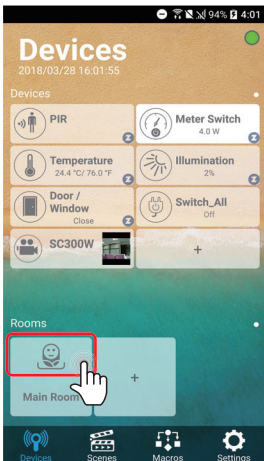

11 Delete the Room -2

Click "Delete" icon to delete the Room.

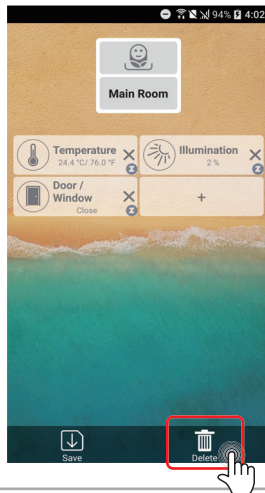

APP Operation Guide

Scene Setting

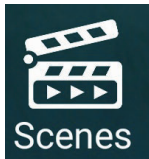

Scene Setting
Create Multiple Actions

01 Add New Scene

Go to "Scenes" page to click "+"

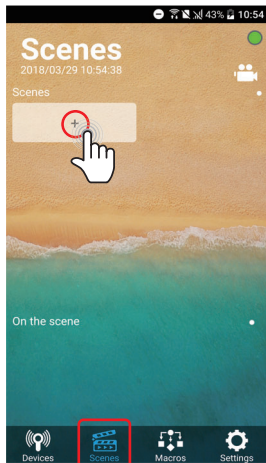

APP Operation Guide

Scene Setting

02 Provide a Name for Scene

Click "Scene name" field and provide a name for the scene.
Click "Icon" and select one icon that you like to use.

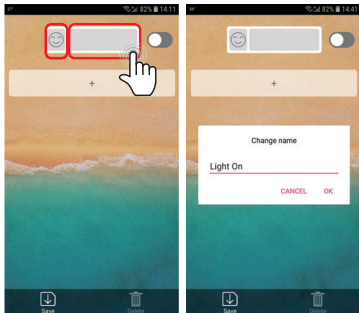

03 Add Sensors in Scene

Click "+" to add sensors. To Turn the Scene Invisible move the slider in the right corner to the right.

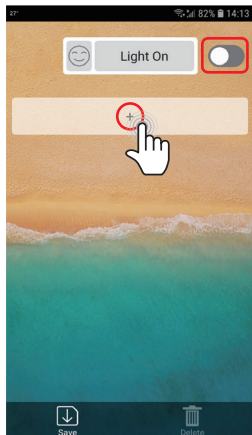

APP Operation Guide

Scene Setting

04 Set the Sensor Action

After adding the sensor, user can set the sensor action and remember to Save the scene.

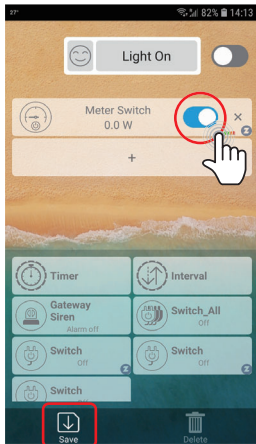

05 Success Add a Scene

After creating the scene, this is how it looks like in scene.

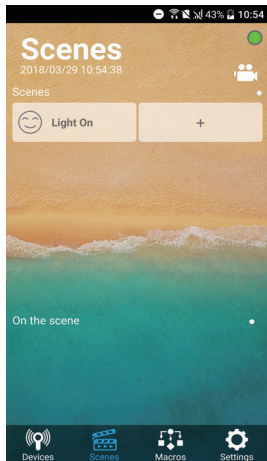

APP Operation Guide

Scene Setting / Marco Setting

06

Execute the Scene

Click on the scene and sensors will do what it was set to do.

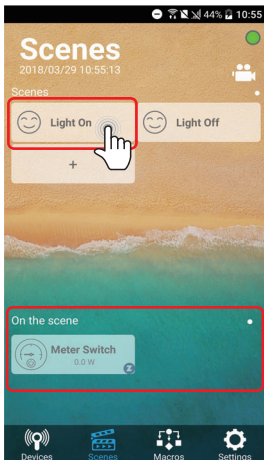

Air Live
Smart Life IOT
For Home

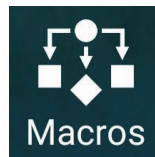

Marco Setting

Create If-Then Conditions

APP Operation Guide

Marco Setting

00 Macro

1. In the Macro page, the first Red bar is the Main Home Security Alarm, When this one is enabled the Siren will go On and a Notification will be send when any of the Sensors in your home is triggered.
2. The Macro setup, This is were you can make your own Macro's Press the "+" icon to start making your Macro. Example: IF PIR is triggered THEN Smartplug On.

01 Quickly Launch Intruder Alarm

- After login the gateway to click "Macros" tab
- Click the padlock to close/open, then security will be in armed/disarmed mode.

Note: If door/window or PIR is triggered, user will receive a notification and Siren will sound.

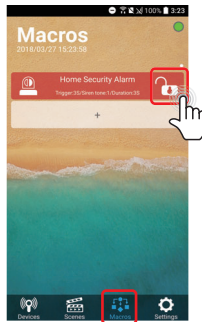

APP Operation Guide

Marco Setting

02 Setting Intruder Alarm

- Click "Home Security Alarm" on screen
- Trigger: Set the duration for triggering the alarm in armed mode
- Siren Tone: To decide which tune of siren to be used. (There are 6 tones)
- Duration: Set the Duration of the alarm.

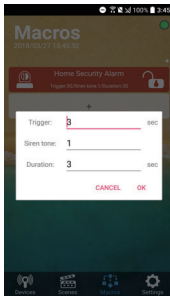

01 Add New Macro

Go to "Macros" page to click "+"

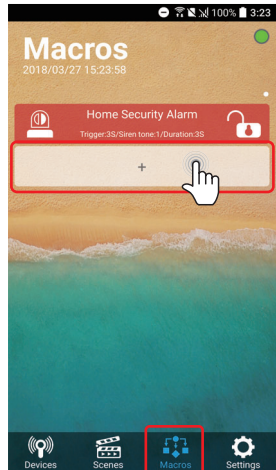

APP Operation Guide

Marco Setting

02 Provide a Name for Marco

Click "Macro name" field and provide a name for the Marco.

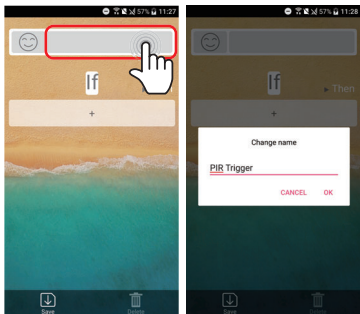

03 Set IF condition

Click "+" to add sensor into IF condition. "OR" gives the option to add more sensors to your Macro. The "OR" option will appear automatically after the first sensor has been added. For example PIR sensor "OR" Door/Window sensor is triggered THEN action.



APP Operation Guide

Marco Setting

04 Set Marco Schedule -1

Click the date to set the schedule.

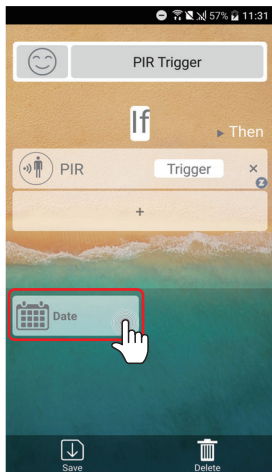

05 Set Marco Schedule -2

Click  icon to set the time that you wish.

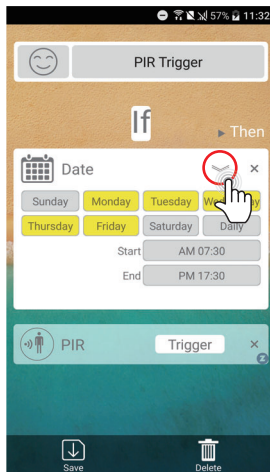

APP Operation Guide

Marco Setting

06 Set Then Action

Click "+" to add device into Then action.

Note: For setup Then, user can select "Device" or "Scenes"

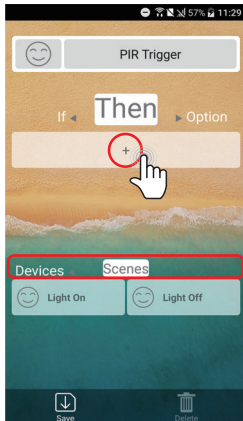

07 Set Option Criteria -1

- User can specify the action duration.
- To receive a alert when the macro is triggered, tap the switch beside the notification.

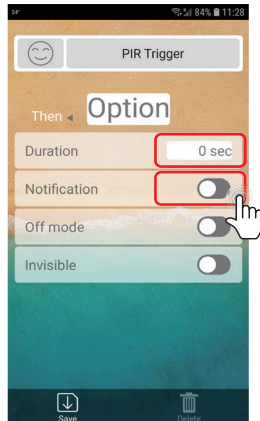

APP Operation Guide

Marco Setting

08 Set Option Criteria -2

- Enable Off Mode to turn off a device after a set duration when the device was On before the Trigger.
- To make the Macro Invisible, tap the switch beside Invisible.
- Remember to save the marco if you finish the setting.

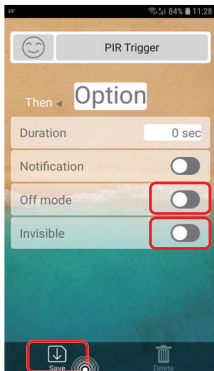

09 Success Add a Marco

After creating the marco, you can now turn it on/off on your phone.

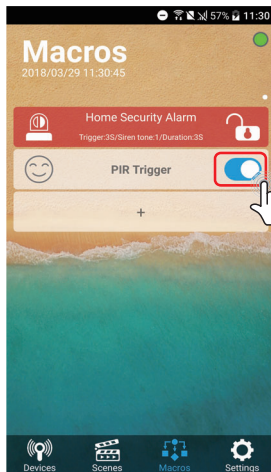

APP Operation Guide

Advance Setting

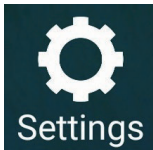

Advance Setting
Advance setting for
Gateway & APP

01 Advance Information

In Setting page you could retrieve APP and the gateway detailed information by clicking into each option.

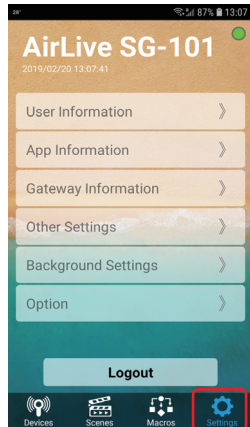

APP Operation Guide

Advance Setting

02 User Information

Input the username, e-mail address and password.

Note: Only supports Google mail, please confirm the password is correct.

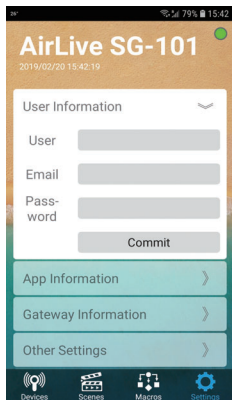

03 Change the Google security setting -1

Login to your Google account

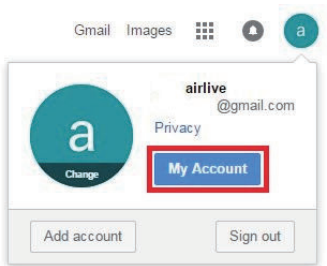

APP Operation Guide

Advance Setting

04 Change the Google security setting -2

Click on "Security"

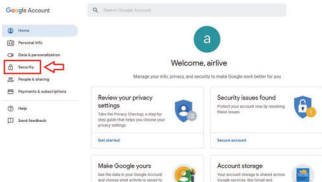

05 Change the Google security setting -3

Go to "Less secure app access" and change the setting from "OFF" to "ON"

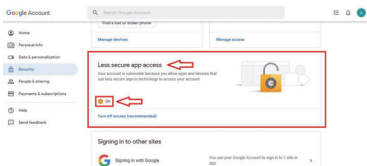

APP Operation Guide

Advance Setting

06

Quickly Launch Intruder Alarm

Go to Marcos page to click the padlock to close now trigger a sensor.

Note: If door/window or PIR is triggered, user will receive a notification and Siren will sound.

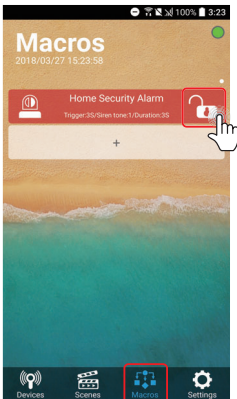

07

Make sure receive the Notification on Phone

Alarm door/window sensor or PIR motion sensor, you will be able to receive a notification on phone.

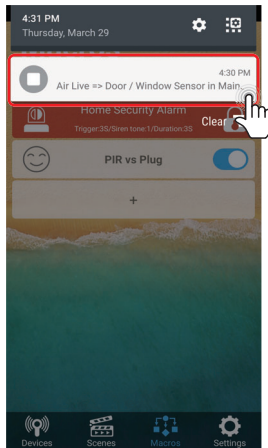

APP Operation Guide

Advance Setting

08 Make sure receive the E-mail

Alarm door/window sensor or PIR motion sensor, you will be able to receive a E-mail.

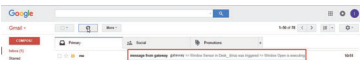

09 APP Information

Language: Change the APP's language by click the Globe icon (Android).

APP Ver.: Show APP current version.

User Manual: Download the APP Guide.

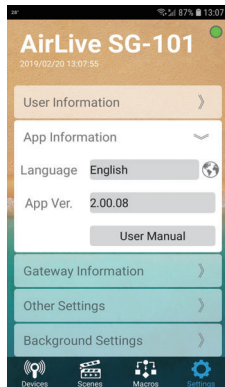

APP Operation Guide

Advance Setting

10 Gateway Information

Gateway ver. : Click ↑ icon to update the Firmware.

Gateway Time: Change the time zone by click clock icon.

Wi-Fi network: Change the wi-fi mode AP/Station or Off by clicking on the wifi icon. Recommend to Change after first start up!

Location: Define the Gateway's location by clicking the position icon.

Host Name: This is the name of the Gateway used in the AirLive Cloud. You can enter your own name for the Gateway.

UID: This is the UID of the Gateway which is in use.



11 Other Settings -1

Advance Setting:

Enter the Gateway's Advanced setting page.

Reboot Gateway:

Restart the Gateway.

Backup Setting:

Backup the Gateway's configuration settings

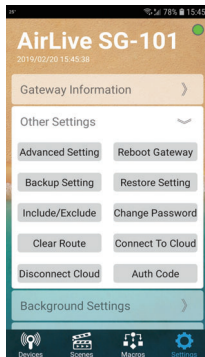

APP Operation Guide

Advance Setting

12 Other Settings -2

Restore Setting:

Restore the configuration settings into Gateway.

Include/Exclude:

Execute including/excluding device.

Change Password:

Change the Gateway and Lock Setting Password. Clear Route: Allow to Change the Z-Wave Route.

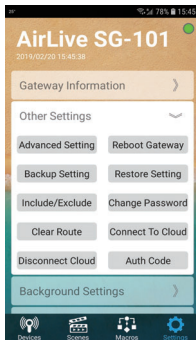

13 Other Settings -3

Connect to Cloud:

Connect the Gateway to the AirLive Cloud.

Disconnect Cloud:

Disconnect the Gateway from AirLive Cloud.

Auth Code:

Bind the gateway to AirLive Cloud.

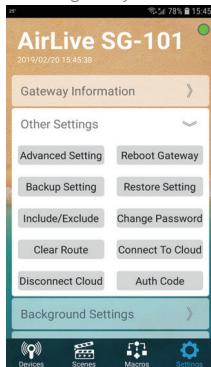

APP Operation Guide

Advance Setting

14 Background Settings

Change the background picture.

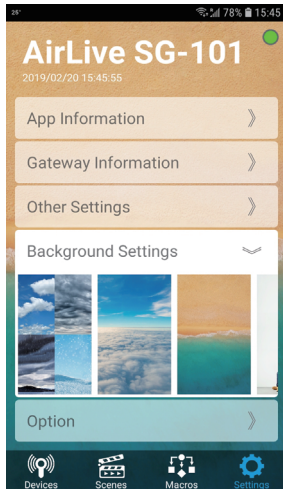

15 Option -1

Mark "V" to enable the setting that you wish.

Auto Login:

Under Development.

Lock Room:

Room Settings cannot be changed.

Lock Scene:

Scene Settings cannot be changed

Lock Macro:

Macro Settings cannot be changed.

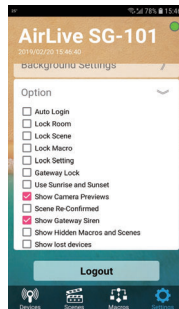

APP Operation Guide

Advance Setting

16 Option -2

Lock Setting:

Add password to "Others settings" and "Option" menu.

Gateway Lock:

Changes cannot be made to Scene, Macro and Room.

Use Sunrise and Sunset:

Sunrise and Sunset option added to Device page, Make sure Time and Location have been setup first!

Show Camera Previews:

Camera will be show in preview

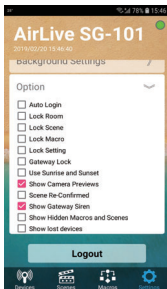

17 Option -3

Scene Re-Confirmed:

A Scene in the Scene menu will be double checked when activated.

Show Gateway Siren:

Siren will be shown in Device page.

Show Hidden Macros and Scenes:

Hidden Macros and Scene will show up again their menu's.

Show Lost Devices:

Devices which are not connected but still in the device page will be shown with a "!".

