

Air Live
Smart Life 



Smart Home Kit QIG for APP



● APP Operation Guide

● APP introduce	1
● Devices Setting	4
● Room Setting	5
● Scene Setting	11
● Marco Setting	15
● Advance Setting	20

APP Operation Guide

APP introduce



AirLive Smart Life Plus APP Operation Guide

About the Smart Life Plus APP

AirLive Smart Life Plus APP features “**Smart Rules**” to make your life easier.

Devices: Turn on/off individual devices.

Room: Create different settings for rooms around the house

Scene: Make multiple actions such as turning on multiple lightings at the same time.

Macro: Set “**IF->Then**” conditions. For example, if the interior illumination is below certain level, the light will turn on.

APP Operation Guide

APP introduce

01 Execute the Smart Life Plus APP

Click the "AirLive Smart Life Plus"
icon on your smart phone

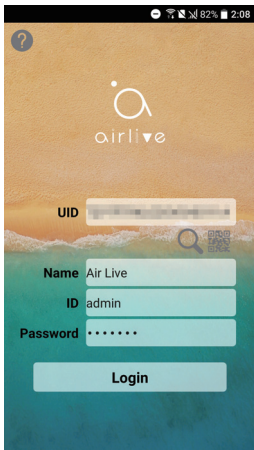

02 Download APP User's Guide

You can click "Question mark" to
download the user's guide for APP
operation.

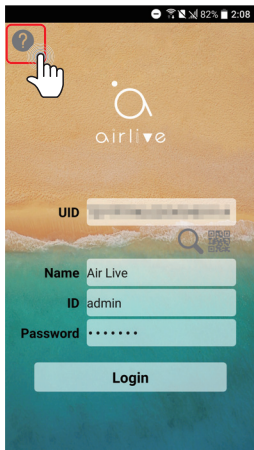

APP Operation Guide

APP introduce

03 Quickly Launch Intruder Alarm

- After login the gateway, click "Macros" tab
- Click the padlock to close, then security will be in armed mode.

Note: If door/window or PIR is triggered, user will receive a notification and Siren will sound.

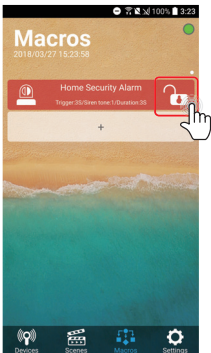

04 Devices Screen

All included sensors will be shown on the Devices Tab.

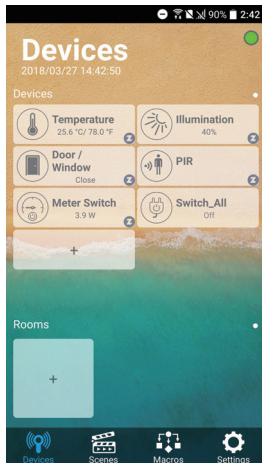

APP Operation Guide

Device Setting

Air Live
Smart Life IOT
For Home

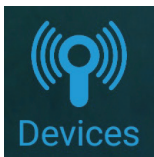

Device Setting

01 Change Sensor's Name-1

- After login the gateway to click "Devices" tab
- Click sensor icon to enter the sensor page.

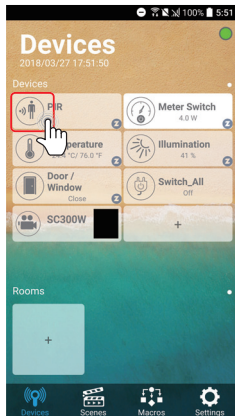

APP Operation Guide

Device Setting / Room Setting

02 Change Sensor's Name-2

You can change the sensor's name.
And you can view sensor's event and other settings.

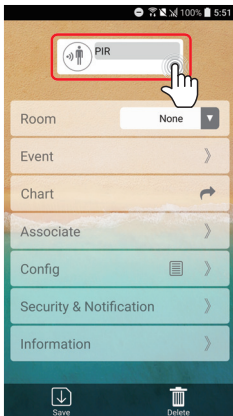

Air Live Smart Life IOT For Home

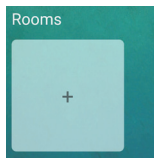

Room Setting

APP Operation Guide

Room Setting

01 Add New Room

Go to Device tab, click "+" icon to create a room.

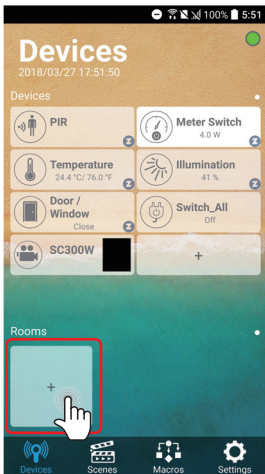

02 Provide a Name for Room

Click "Room name" field and provide a name for the room.

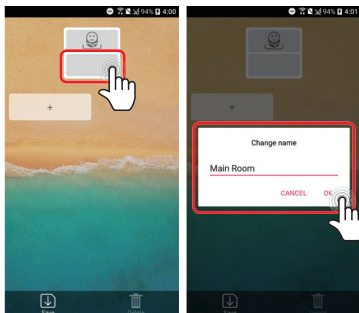

APP Operation Guide

Room Setting

03 Add Sensors in Room

Click "+" to add sensors and Save the room.

Note: Once a sensor has already been placed in a room, it cannot be added to another room.

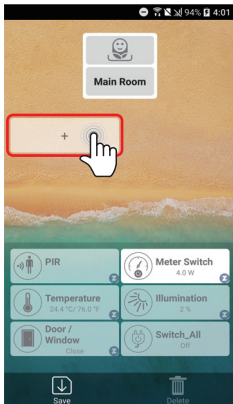

04 Success Add a Room

After creating the room, this is how it looks like in room



APP Operation Guide

Room Setting

05 Sensors in Room

Click Room name icon to see what sensors in the created Room.

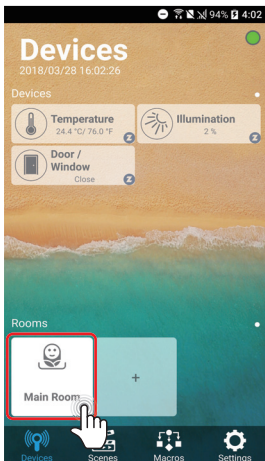

06 Change Room Icon -1

Click Room icon to enter the Room setting page.

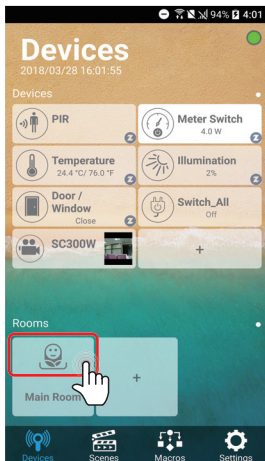

APP Operation Guide

Room Setting

07 Change the Room Icon -2

Click icon and select one icon that you want and remember to save the new settings.



08 Delete the sensor from Room-1

Click Room icon to enter the Room setting page.

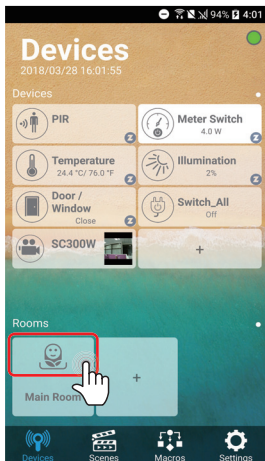

APP Operation Guide

Room Setting

09

Delete the sensor from Room -2

Click “X” to delete the sensor and remember to save the new settings.

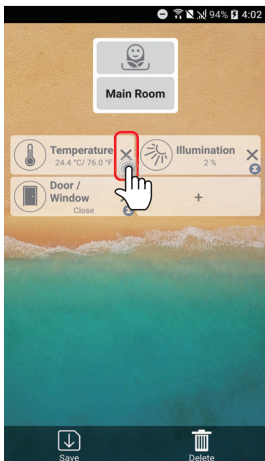

10

Delete the Room -1

Click Room icon to enter the Room setting page.

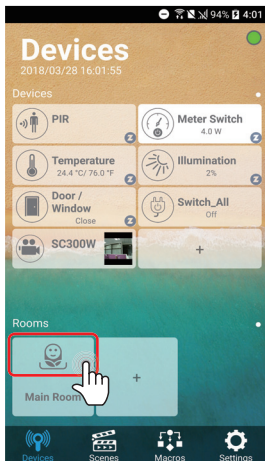

APP Operation Guide

Room Setting / Scene Setting

11 Delete the Room -2

Click "Delete" icon to delete the Room.

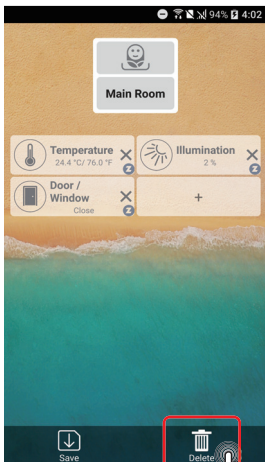

Air Live
Smart Life IOT
For Home

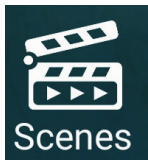

Scene Setting

Create Multiple Actions

APP Operation Guide

Scene Setting

01 Add New Scene

Go to "Scenes" page to click "+"

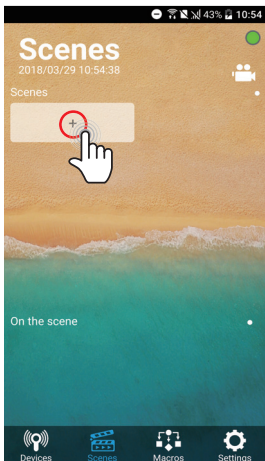

02 Provide a Name for Scene

Click "Scene name" field and provide a name for the scene.

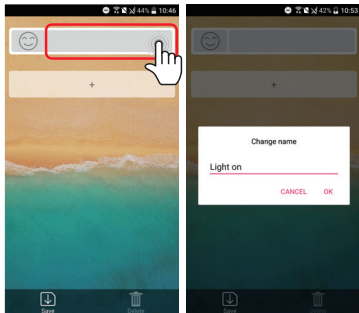

APP Operation Guide

Scene Setting

03 Add Sensors in Scene

Click "+" to add sensors.

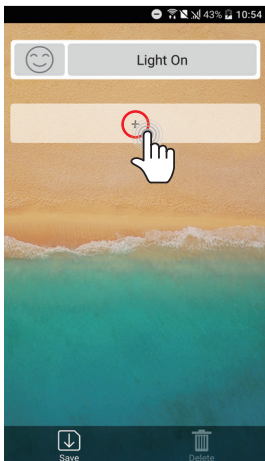

04 Set the Sensor Action

After adding the sensor, user can set the sensor action and remember to Save the scene.

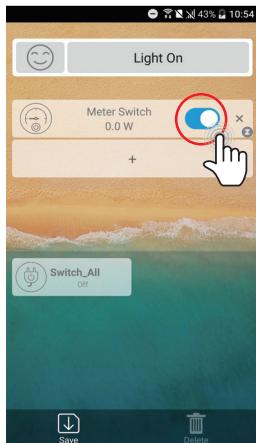

APP Operation Guide

Scene Setting

05 Success Add a Scene

After creating the scene, this is how it looks like in scene.

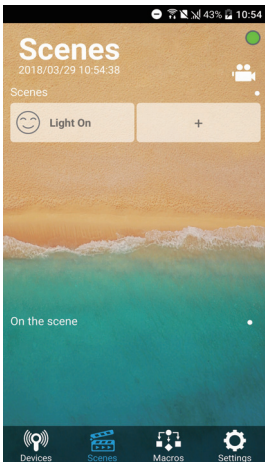

06 Execute the Scene

Click on the scene and sensors will do what it was set to do.

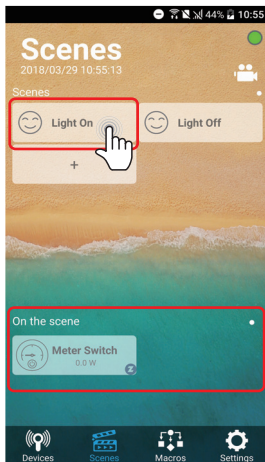

APP Operation Guide

Marco Setting

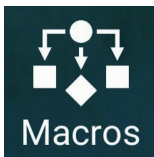

Marco Setting

Create If-Then Conditions

01 Add New Macro

Go to "Macros" page to click "+"

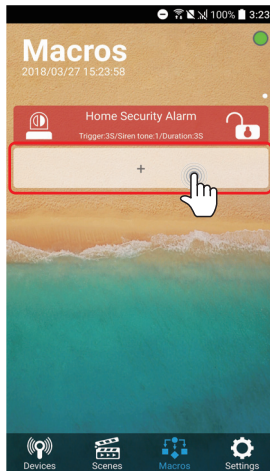

APP Operation Guide

Marco Setting

02 Provide a Name for Marco

Click "**Macro name**" field and provide a name for the Marco.

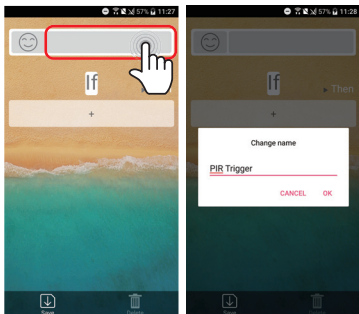

03 Set IF condition

Click "+" to add sensor into IF condition.



APP Operation Guide

Marco Setting

04 Set Marco Schedule -1

Click the date to set the schedule.

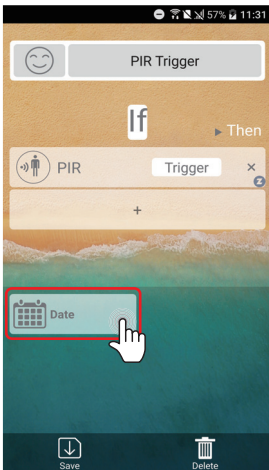

05 Set Marco Schedule -2

Click  icon to set the time that you wish.

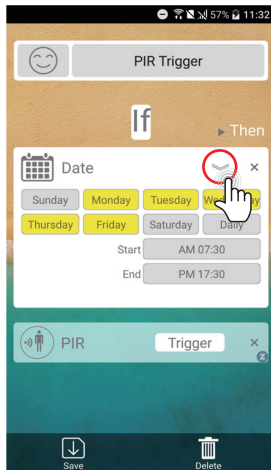

APP Operation Guide

Marco Setting

06 Set Then Action

Click "+" to add device into Then action.

Note: For setup Then, user can select "Device" or "Scenes"



07 Set Option Criteria -1

User can specify the action duration.

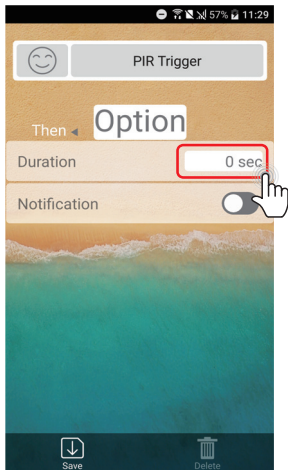

APP Operation Guide

Marco Setting

08 Set Option Criteria -2

- To receive a alert when the macro is triggered, tap the switch beside the notification.
- Remember to save the marco if you finish the setting.

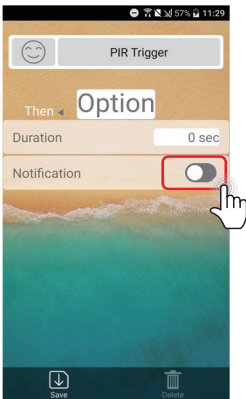

09 Success Add a Marco

After creating the marco, you can now turn it on/off on your phone.

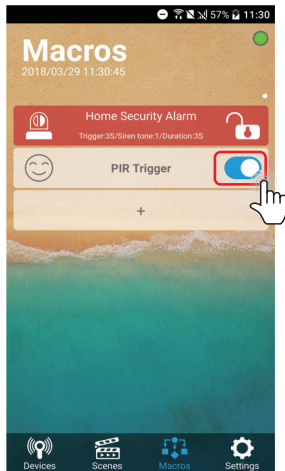

APP Operation Guide

Advance Setting

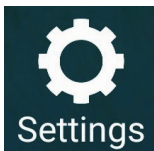

Advance Setting

Advance setting for
Gateway & APP

01 Advance Information

In Setting page you could retrieve APP and the gateway detailed information by clicking into each option.

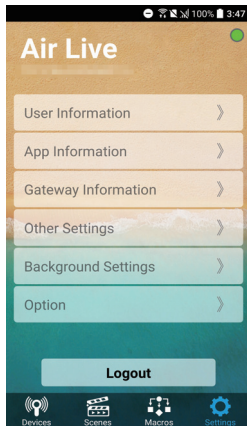

APP Operation Guide

Advance Setting

02 User Information

Input the username, e-mail address and password.

Note: Only support google mail, please confirm the password is correct.

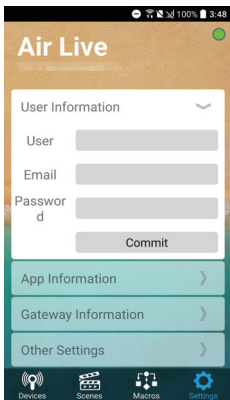

03 Change the Google security setting -1

Login to your Google account

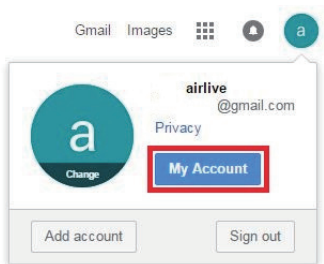

APP Operation Guide

Advance Setting

04 Change the Google security setting -2

Click on
“Connected Apps and Sites”

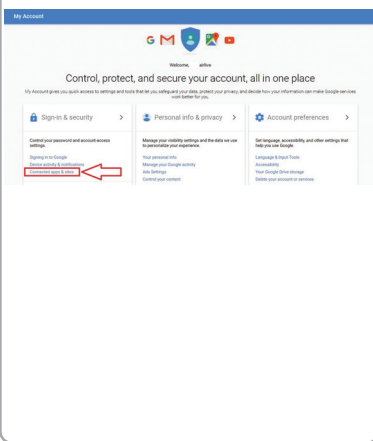

My Account

Welcome, active

Control, protect, and secure your account, all in one place

My Account gives you quick access to settings and tools that let you manage your privacy, protect your data, control your privacy, and decide how your information can make Google services work better for you.

Sign-in & security >

Control your password and account access settings

Signing in to Google

Change whether to auto-sign in

Connected apps & sites

Personal info & privacy >

Manage your visibility settings and the data we use to personalize your experience

Your personal info

Manage your Google activity

App settings

Control your content

App preferences >

Get language, accessibility, and other settings that help you use Google

Language & input tools

Accessibility

Your Google Drive storage

Secure your account or services

05 Change the Google security setting -3

Go to “Allow less secure apps” and change the setting from “OFF” to “ON”

Connected apps & sites

Keep track of which apps and sites you have approved to connect to your account, and remove ones you no longer use or trust.

Apps connected to your account

Make sure you still use these apps and want to keep them connected.

REMOVE APPS

Save passwords

You have no saved passwords.

LEARN MORE

Allow less secure apps: OFF

Some non-Google apps and devices use less secure sign-in technology, which could leave your account vulnerable. You can turn off access for these apps (which we recommend) or choose to use them despite the risks.

APP Operation Guide

Advance Setting

06 Quickly Launch Intruder Alarm

Go to Marcos page to click the padlock to close.

Note: If door/window or PIR is triggered, user will receive a notification and Siren will sound.

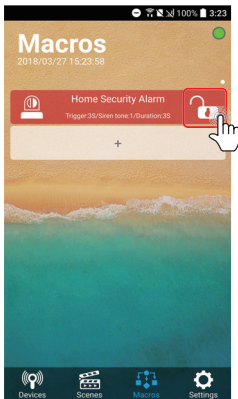

07 Make sure receive the Notification on Phone

Alarm door/window sensor or PIR motion sensor, you will be able to receive a notification on phone.

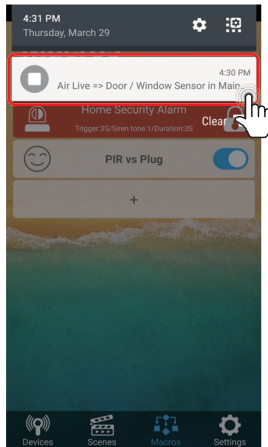

APP Operation Guide

Advance Setting

08 Make sure receive the E-mail

Alarm door/window sensor or PIR motion sensor, you will be able to receive a E-mail.



09 APP Information

Language: Change the APP's language by click the earth icon.

APP Ver.: Show APP current version.

User Manual: Download the user's manual.

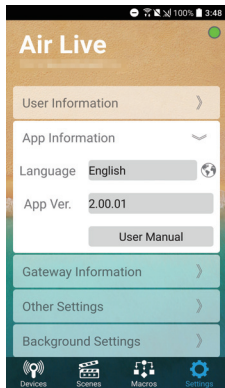

APP Operation Guide

Advance Setting

10 Gateway Information

Gateway ver.: Check if there is a new FW by click ↑ icon.

Gateway Time: Change the timezone by click clock icon.

Wi-Fi network: Change the wi-fi mode by click single icon.

Location: Define the gateway's location by click position icon.



11 Other Settings -1

Advance Setting:

Enter the gateway's advance setting page.

Reboot Gateway:

Restart the Gateway.

Backup Setting:

Backup the gateway's configuration settings to Luffanet server.

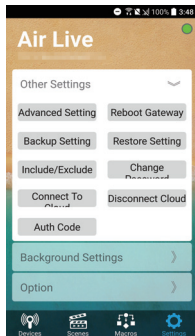

APP Operation Guide

Advance Setting

12 Other Settings -2

Restore Setting:

Restore the configuration settings into gateway.

Include/Exclude:

Execute including/excluding device.

Change Password:

Change the gateway's password.

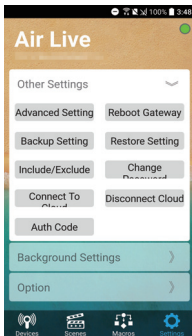

13 Other Settings -3

Connect to Cloud:

Connect the gateway to Luffanet server.

Disconnect Cloud:

Disconnect the gateway from Luffanet server.

Auth Code:

Bind the gateway to Luffanet server

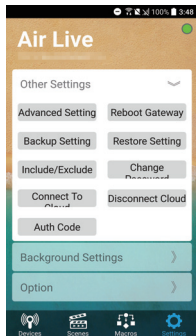

APP Operation Guide

Advance Setting

14 Background Settings

Change the background picture.

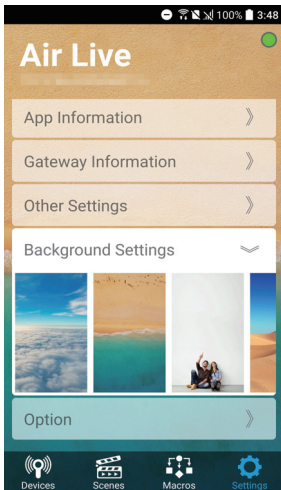

15 Option

Mark "V" to enable the setting that you wish.

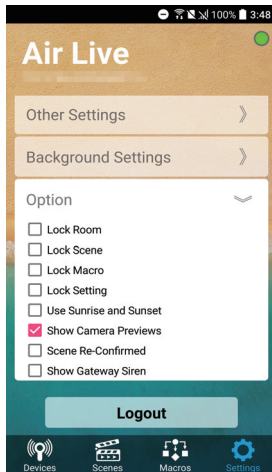

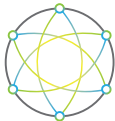

Air Live
Smart Life  IOT
For Home



Smart Home Kit QIG for APP